

## Metal Deck - (no ceiling)

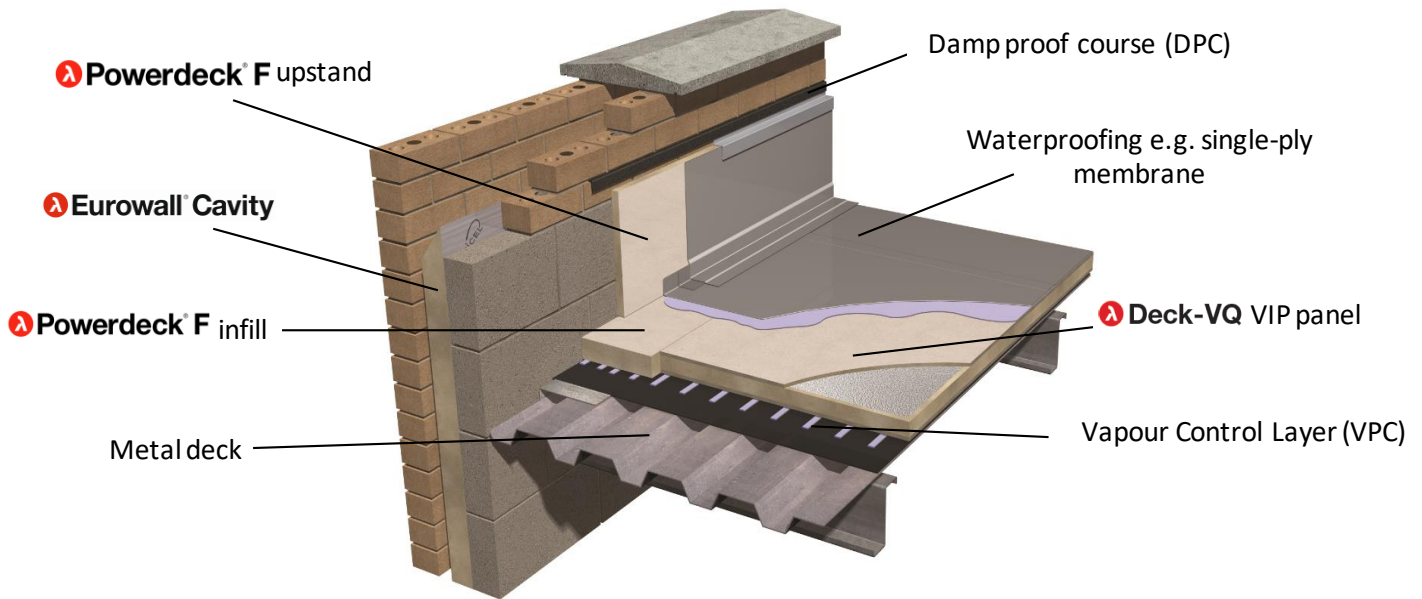

U-Value W/m <sup>2</sup> K	Deck-VQ thickness (mm)	Powerdeck F thickness (mm)	Total Insulation thickness (mm)
0.18	45mm	40mm	85mm
0.16	60mm	20mm	80mm
0.15	60mm	30mm	90mm
0.14	60mm	40mm	100mm
0.13	45mm + 45mm	N/A	90mm
0.12	60mm	60mm	120mm
0.11	60mm	80mm	140mm
0.10	60mm	100mm	160mm
0.09	60mm + 60mm	N/A	120mm
0.08	60mm + 60mm	40mm	160mm

Deck-VQ 45mm – 0.009W/mK

Deck-VQ 60mm – 0.008W/mK

Powerdeck F – (≥ 120mm = 0.024W/mK, 80mm – 119mm = 0.025W/mK, ≤ 79mm = 0.026W/mK)

\*\*\* The above guide U-values have been calculated using Deck-VQ 45mm and 60mm (stock items). Other thicknesses are available to suit your project requirements. Our technical team can work with you to determine the optimum thickness which is required \*\*\*

\*\*\* Guide U-values shown assume a 20% bridging factor of PIR infill against Deck-VQ. For an accurate bridging percentage, project details will be required, where our technical team can calculate the exact bridging factor and resultant U-value achieved \*\*\*